

Web Bonus: Oh Look! Twin Size Quilt

Based on a Design by
KRISTEN LAWSON

SKILL LEVEL
CONFIDENT BEGINNER

Finished Quilt Size
68" x 92"

Number of Blocks & Finished Size
18 X Blocks 12" x 12"
17 O Blocks 12" x 12"

Planning & Cutting

This modern I-Spy quilt uses cotton solid fabrics surrounding squares of fun novelty prints, each different than the next. While the white and navy solid fabrics are consistent throughout, there are a variety of similar green, aqua and light blue solids to surround the print squares. Our instructions have you cut 18 width of fabric strips of the assorted solids, but if you prefer to use more colors you can make shorter strip sets of as many colors as you like.

Use an accurate 1/4" seam allowance throughout to ensure all elements of the quilt fit together well.

Fabric Requirements

| | |
|--|---------------------|
| 35 assorted novelty prints (blocks) | 9" x 9" square each |
| White solid (blocks, border) | 3 3/4 yds. |
| Navy solid (blocks, binding) | 3 3/8 yds. |
| *Assorted green, aqua and blue solids (blocks) | 1 1/4 yds. |
| Backing (piece lengthwise) | total 6 yds. |
| Batting size | 76" x 100" |
| *Read Planning & Cutting | |

Cutting Instructions

(in order listed)

35 assorted novelty prints—cut from each:

1 square 4 1/2" x 4 1/2"

White solid

*2 strips 4 1/2" x 87", pieced from 5 width of fabric (WOF) strips

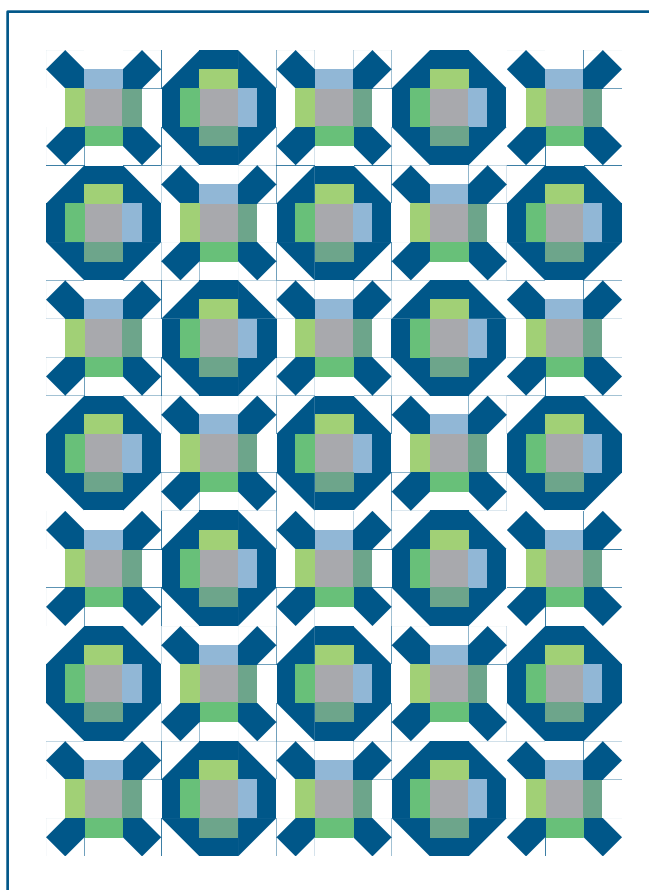

*2 strips 4 1/2" x 71", pieced from 4 WOF strips

9 strips 2 1/2" x WOF

34 squares 4 7/8" x 4 7/8"

216 squares 2 1/2" x 2 1/2"

Navy solid

**18 strips 2 1/2" x WOF

34 squares 4 7/8" x 4 7/8"

72 squares 4 1/2" x 4 1/2"

Assorted green, aqua and blue solids—cut a total of:

18 strips 2 1/2" x WOF

*Border strips include extra length for trimming.

**Set aside 9 strips for binding.

Piecing the Blocks

① Draw diagonal line on wrong side of 3 white solid 2 1/2" squares. Place 2 marked squares on opposite corners of navy solid 4 1/2" square, right sides together, aligning raw edges (**Diagram I**). Sew on marked lines; trim away and discard excess fabric. Open and press. Repeat on 1 additional navy square corner to make corner unit. Make 72.

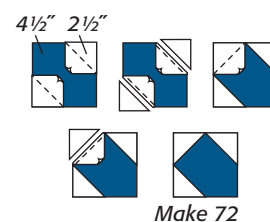

Diagram I

- 2 Sew white $2\frac{1}{2}$ " x WOF strip to green, aqua or blue solid WOF strip to make white strip set (**Diagram II**). Make 9 total. Press in direction of arrow. Cut white strip sets into 72 segments $4\frac{1}{2}$ " wide.

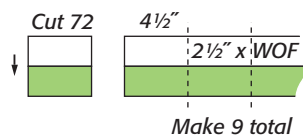

Diagram II

- 3 Referring to **Diagram III**, sew together 4 corner units, 4 different white strip segments and assorted print $4\frac{1}{2}$ " square to make X Block. Make 18 total.

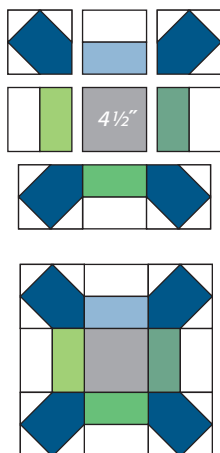

Diagram III

- 4 Draw diagonal line on wrong side of white $4\frac{7}{8}$ " square. Referring to **Diagram IV**, place marked square on navy solid $4\frac{7}{8}$ " square, right sides together. Sew $\frac{1}{4}$ " seam on each side of marked line; cut apart on marked line. Open and press to make 2 pieced squares. Make 68.

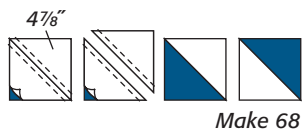

Diagram IV

- 5 Using Step 2 technique, sew navy $2\frac{1}{2}$ " x WOF strip to green, aqua or blue solid WOF strip to make navy strip set (**Diagram V**). Make 9 total. Press in direction of arrow. Cut navy strip sets into 68 segments $4\frac{1}{2}$ " wide.

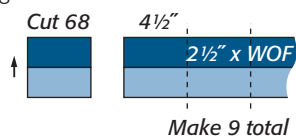

Diagram V

- 6 Referring to **Diagram VI**, sew together 4 pieced squares, 4 different navy strip segments and assorted print $4\frac{1}{2}$ " square to make O Block. Make 17 total.

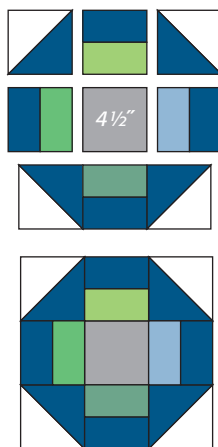

Diagram VI

Assembling the Quilt Top

Note: Refer to **Assembly Diagram** for following steps, watching block placement and orientation.

- 7 Sew 7 rows of 5 blocks each, alternating X and O Blocks as shown. Stitch rows together.

- 8 Sew white 87" strips to sides; trim even with top and bottom. Stitch 71" strips to top/bottom; trim even with sides.

Quilting and Finishing

- 9 Layer, baste, and quilt. Bind with navy solid.

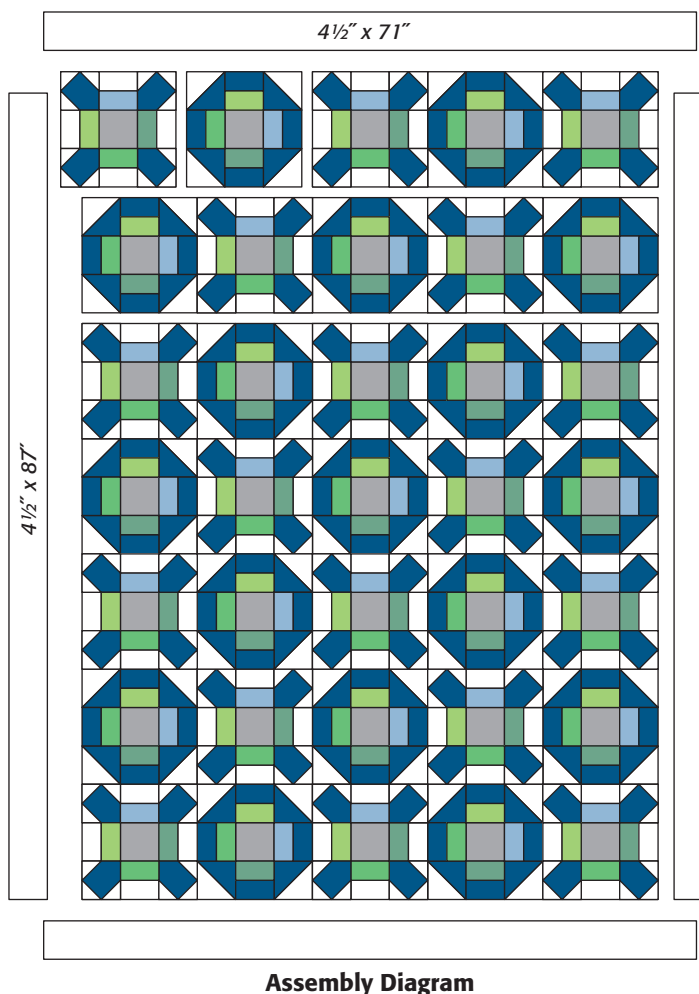

Assembly Diagram