



Pattern Section

For templates that fit on letter size paper:

1. Print desired pattern pages at 100% (no scaling) printer setting, unless otherwise noted.

For templates that extend onto more than one letter-size paper sheet:

1. Print desired pattern pages at 100% (no scaling) printer setting.
2. Arrange so that registration marks align on both template pieces.
3. Trim overlapping portion at aligned sets of registration marks, carefully aligning edges of template shapes, and tape securely.

Templates in this Issue	Page
Wild Orchid	2
Whitehorse Sky	3
Full Bloom	3
Daisy Trellis	4
Diane's Dersdens	4
Mother's Choice	5
This Day Forward	6-8

For Continuous Bias instructions and video go to
McCallsQuilting.com/ContinuousBias.

Copyright 2017 F+W, a content + ecommerce company. All rights reserved.
Reader has permission to copy contents of this section for personal use.

WILD ORCHID

Print at 100% (no scaling). This box measures 2 inches wide by 1 inch high. Use this as an accuracy guide when printing the Pattern Section.

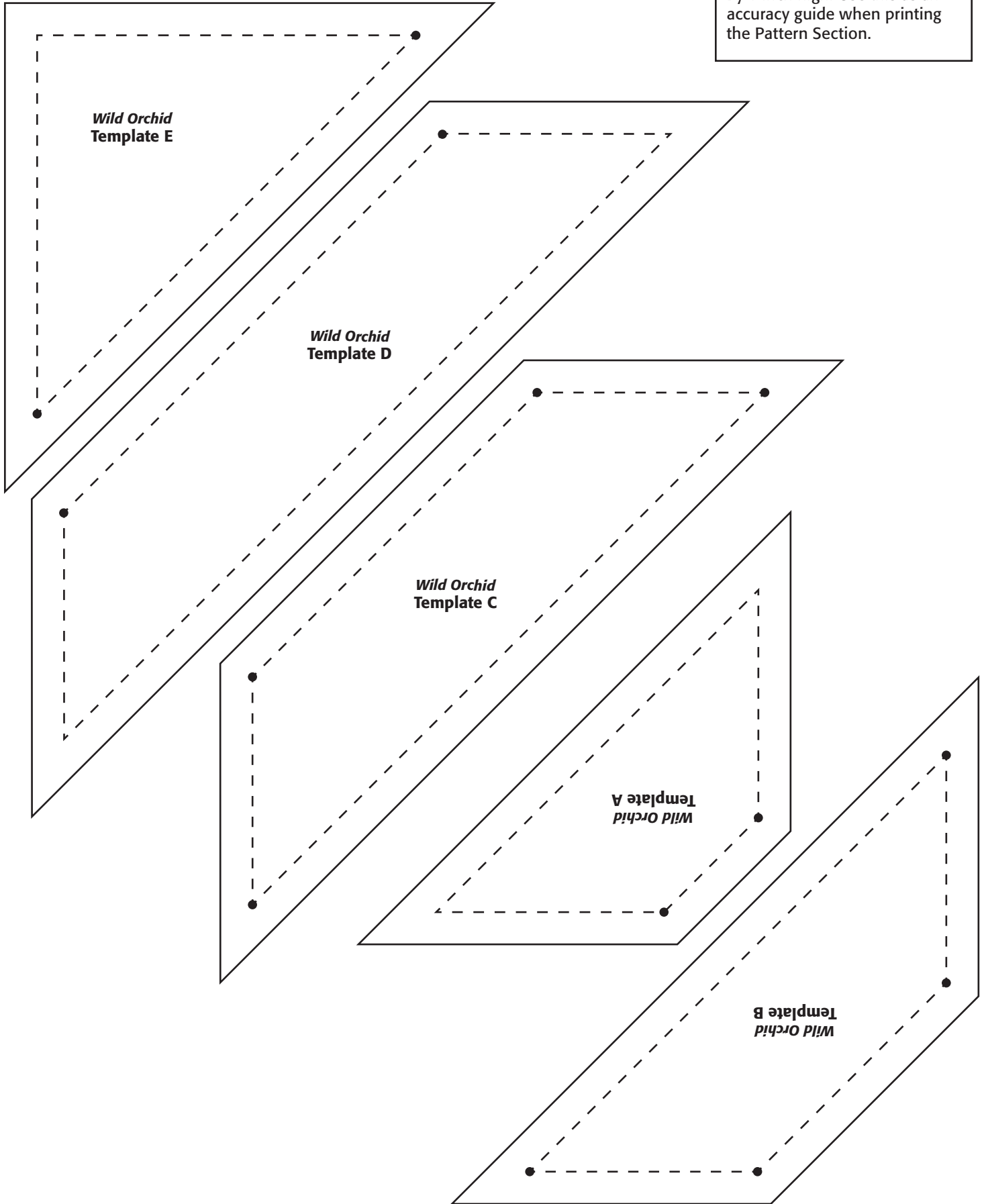

WHITEHORSE SKY

Print at 100% (no scaling). This box measures 2 inches wide by 1 inch high. Use this as an accuracy guide when printing the Pattern Section.

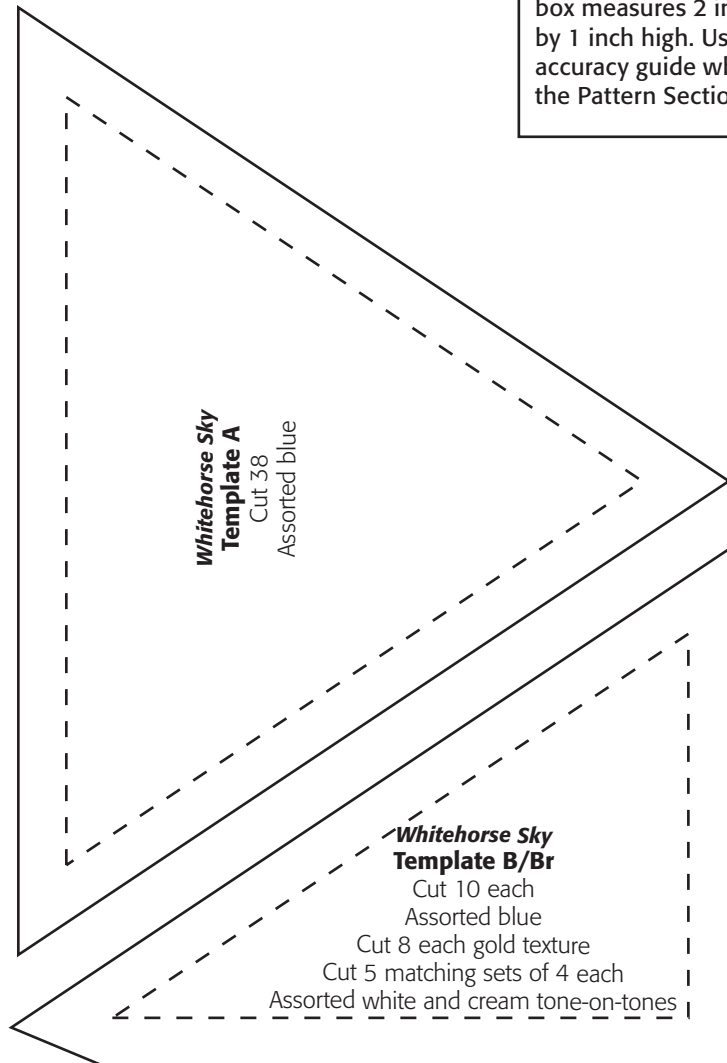

FULL BLOOM

Print at 100% (no scaling). This box measures 2 inches wide by 1 inch high. Use this as an accuracy guide when printing the Pattern Section.

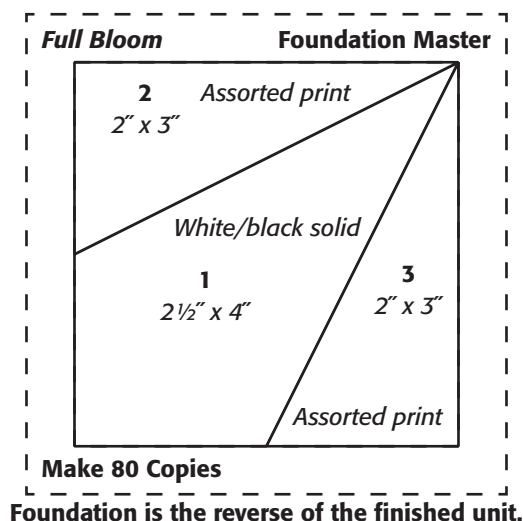

DAISY TRELLIS

Print at 100% (no scaling). This box measures 2 inches wide by 1 inch high. Use this as an accuracy guide when printing the Pattern Section.

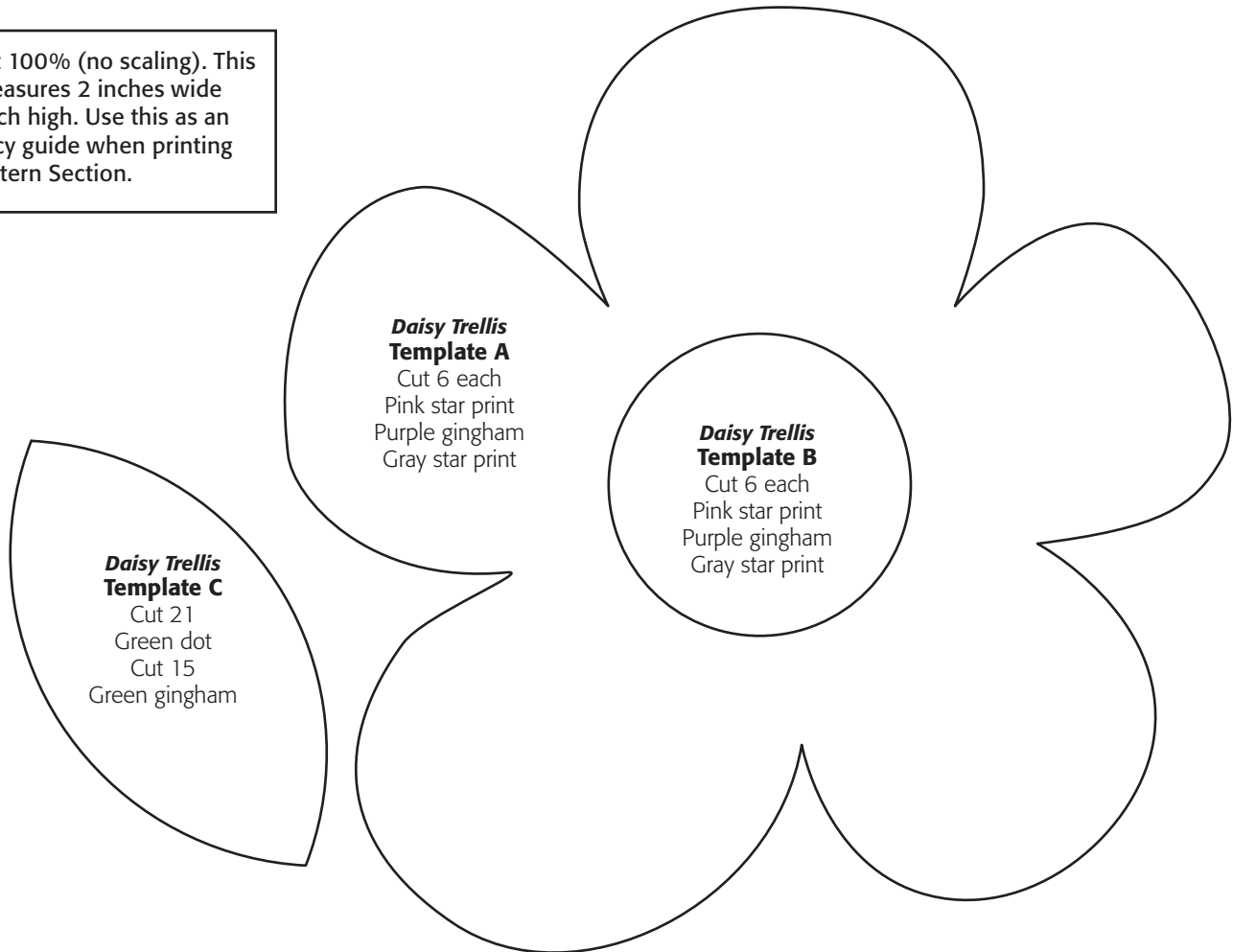

Print at 100% (no scaling). This box measures 2 inches wide by 1 inch high. Use this as an accuracy guide when printing the Pattern Section.

DIANE'S DRESDENS

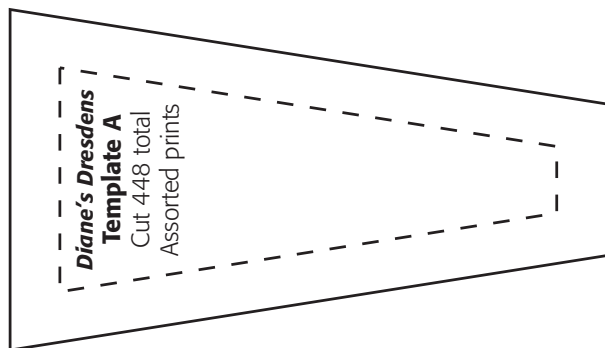

MOTHER'S CHOICE

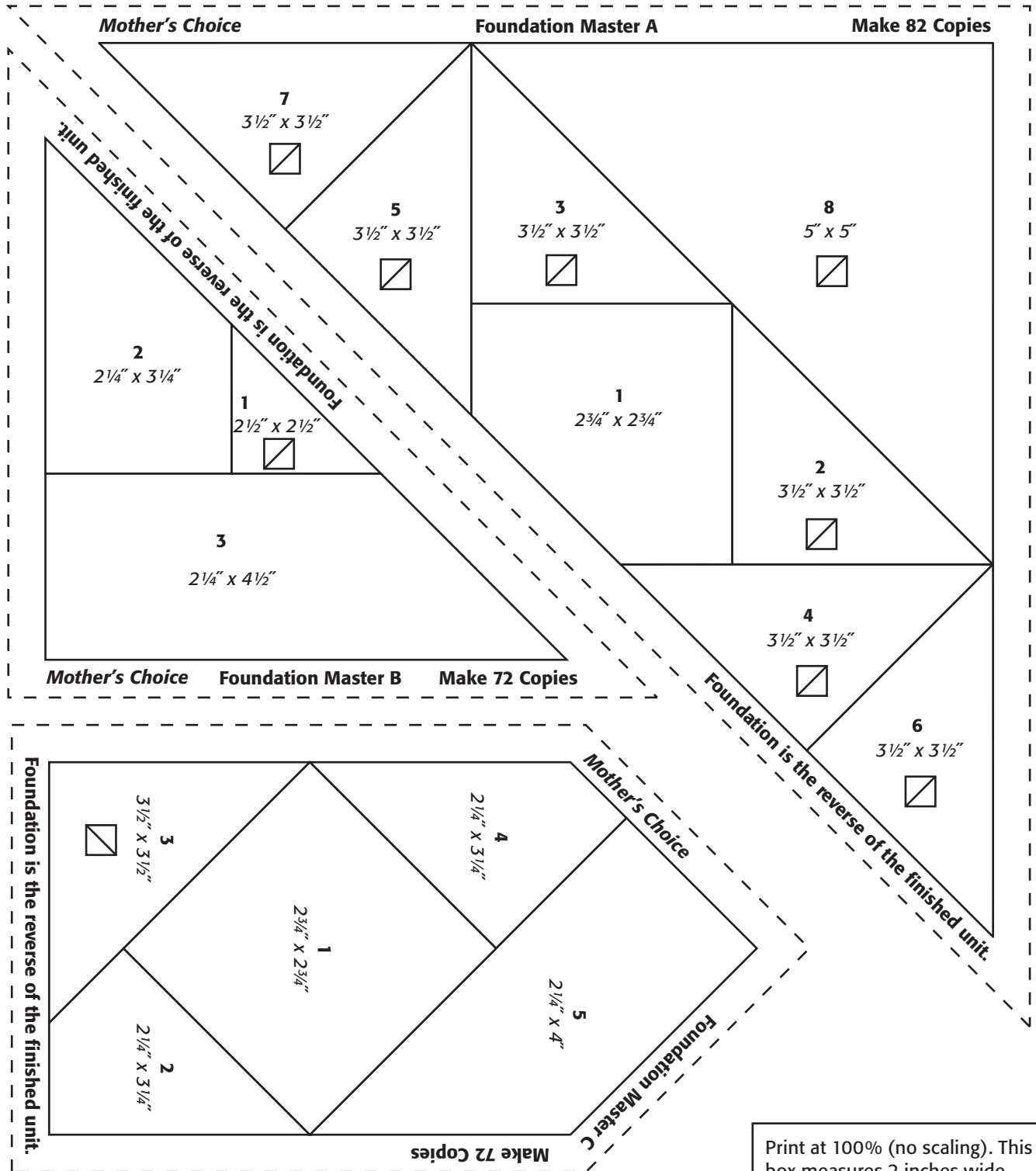

Print at 100% (no scaling). This box measures 2 inches wide by 1 inch high. Use this as an accuracy guide when printing the Pattern Section.

THIS DAY FORWARD

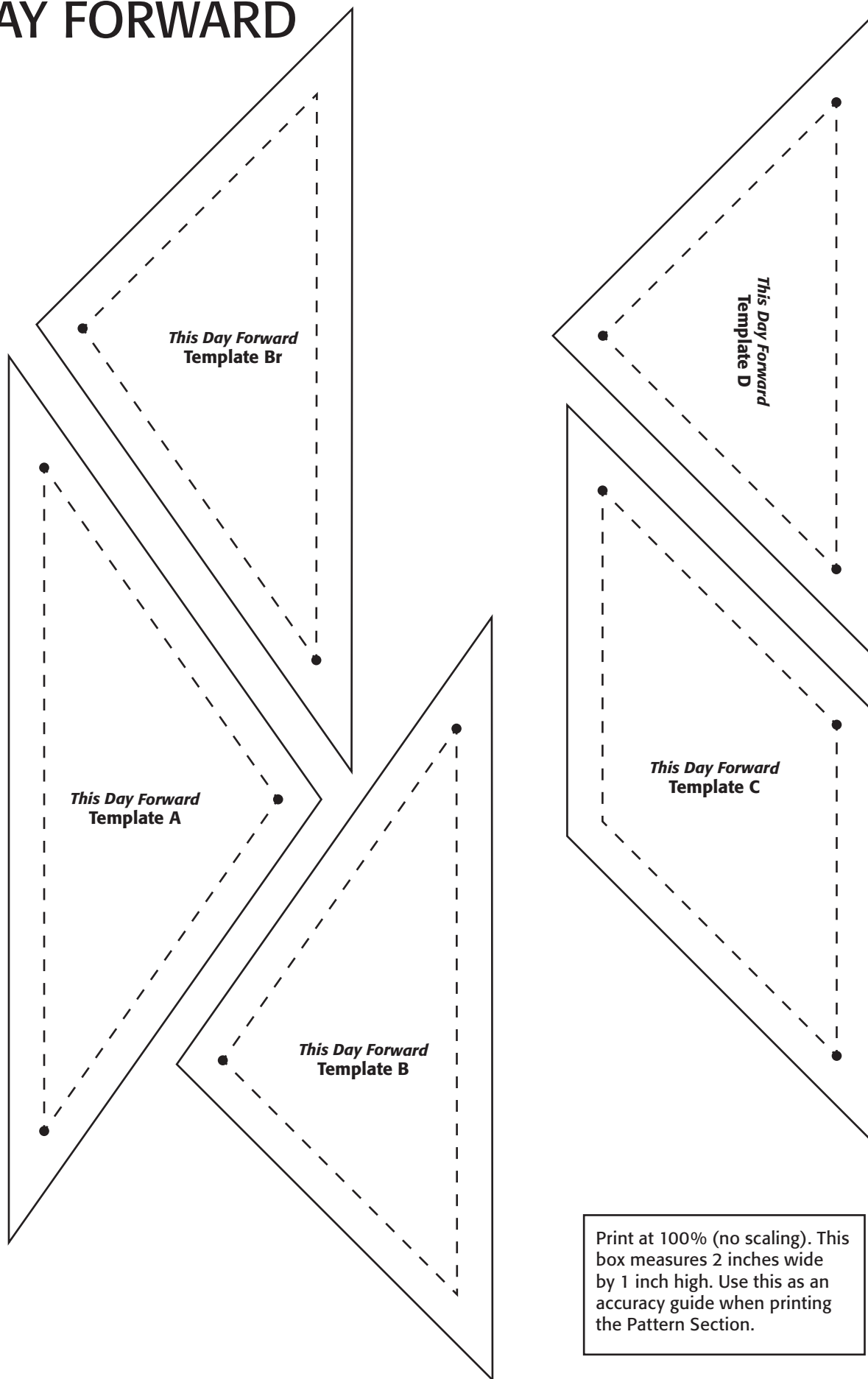

Print at 100% (no scaling). This box measures 2 inches wide by 1 inch high. Use this as an accuracy guide when printing the Pattern Section.

THIS DAY FORWARD

Print at 100% (no scaling). This box measures 2 inches wide by 1 inch high. Use this as an accuracy guide when printing the Pattern Section.

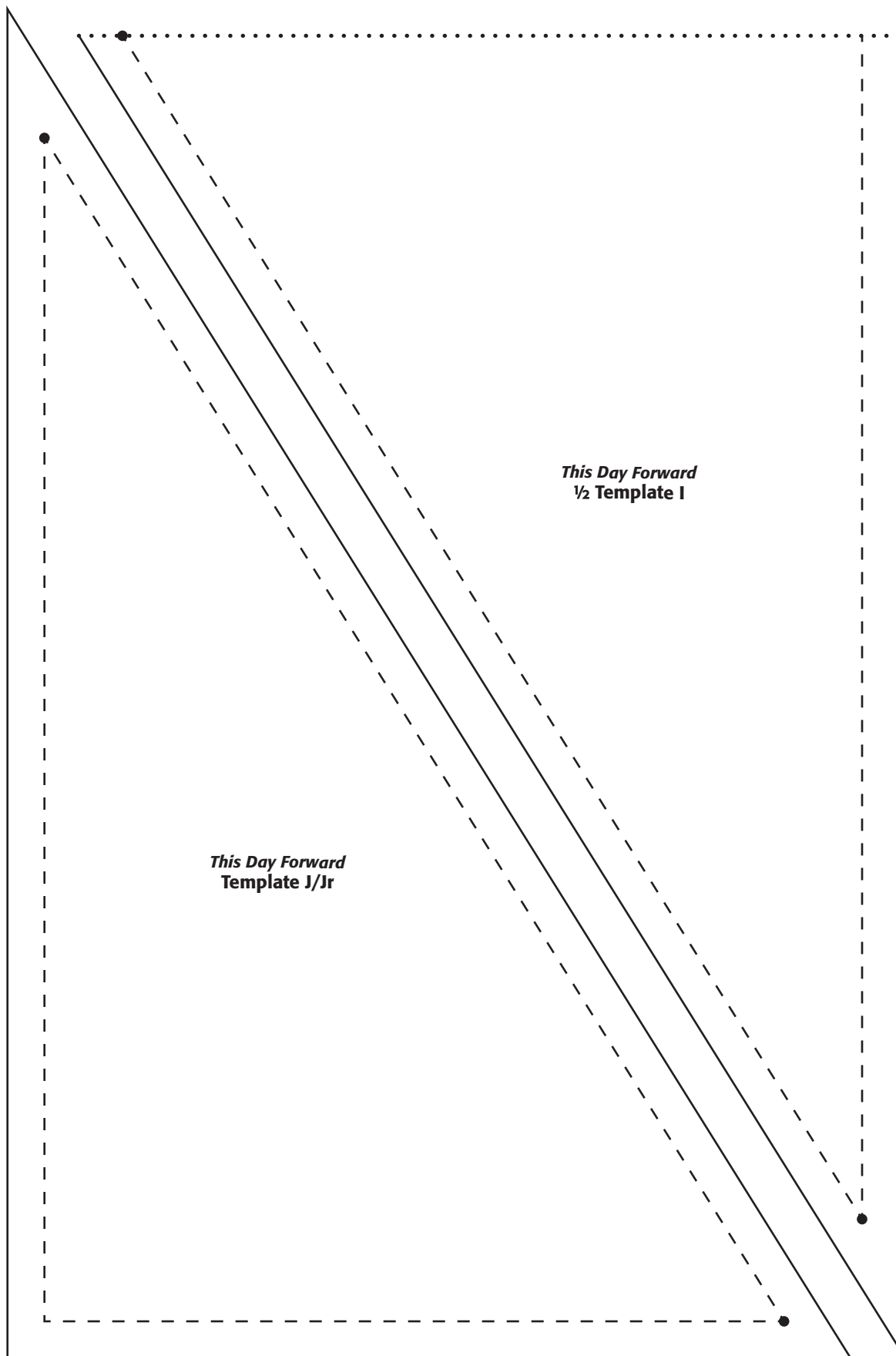

THIS DAY FORWARD

Print at 100% (no scaling). This box measures 2 inches wide by 1 inch high. Use this as an accuracy guide when printing the Pattern Section.

